

APPLICATION

Hydraulic cylinder with piston rods on both sides transfers accumulated in a working liquid pressure energy into mechanical energy which puts the piston in reciprocating motion. When pressure affects the piston area, the piston travels downwards. When pressure affects the piston rod area, the piston returns.

SCHEMAT HYDRAULICZNY

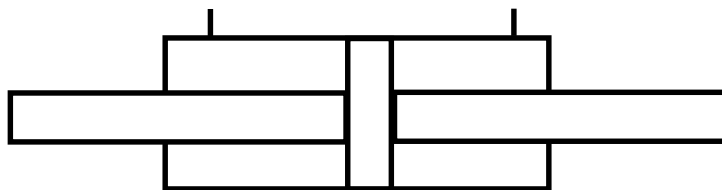

TECHNICAL DATA

Working fluid	Hydraulic oil (viscosity 10÷450 cSt)
Nominal pressure	16 MPa
Required fluid filtration	25 µm
Working temperature range	253÷353 K (-20÷80 °C)
Max piston rod speed	0.5 m/s
efficiency	>0.9
Piston rod coating : chrome	Chrom

OVERALL DIMENSIONS

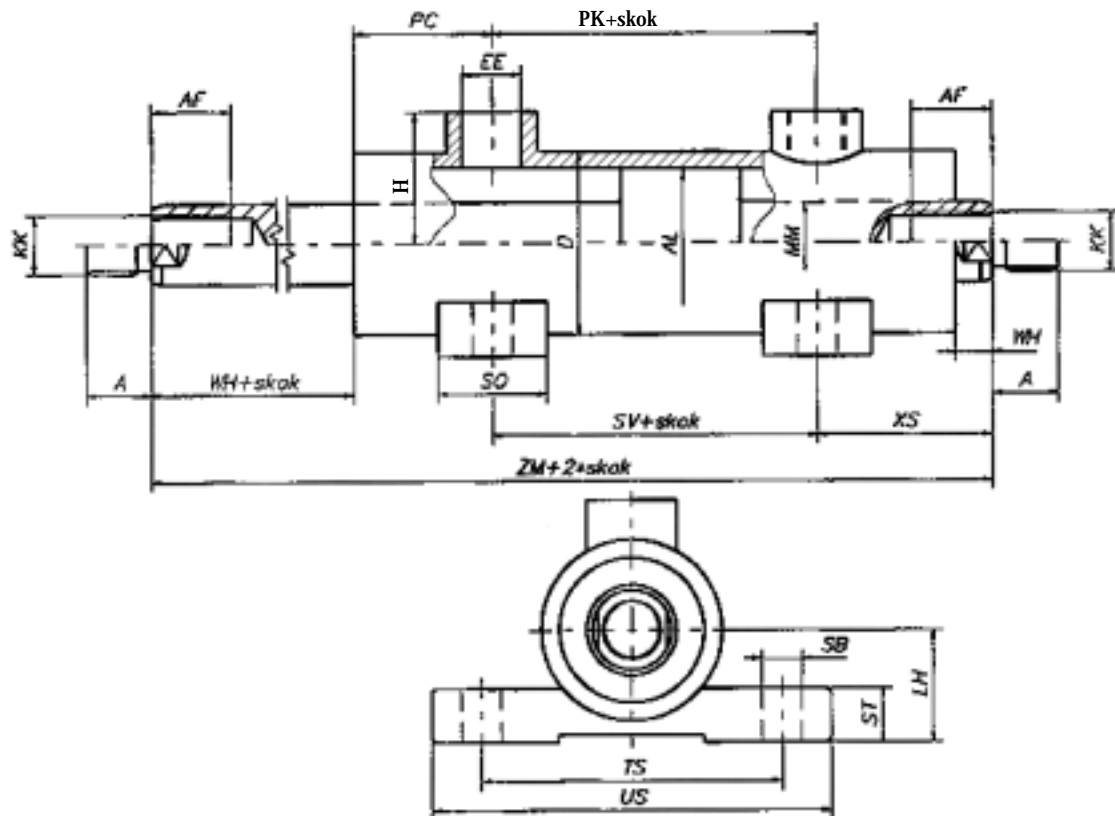

AL	25	32	40	50	63	80	100	125	140	160
MM	18	22	22	28	36	45	56	70	80	90
A	14	16	18	20	22	30	36	45	50	56
AF	16	22	22	30	36	45	50	63	75	85
D	35	42	50	60	76	95	120	146	168	194
EE	M14x1.5	M14x1.5	M16x1.5	M16x1.5	M22x1.5	M27x2	M33x2	M33x2	M33x2	M33x2
H	31	—	36	42	50	62	75	88	98	110
KK	M12x1.5	M16x1.5	M16x1.5	M22x1.5	M27x2	M33x2	M42x2	M48x2	M56x2	M64x2
LH	28	—	31	38	44	57	68	85	95	—
PC	32	—	48	47	59	67	86	85	100	99
PK	—	—	47	59	72	92	114	—	—	—
SB	9	—	11	14	20	20	26	26	30	—
SO	22	—	30	35	50	50	50	60	70	75
ST	12	—	15	18	25	30	35	35	35	—
SV	—	—	47	59	72	92	114	—	—	—
TS	68	—	83	102	124	149	172	205	220	—
US	90	—	110	130	165	190	240	255	280	—
WH	12	—	10	15	15	18	20	23	26	36
XS	44	—	58	62	74	85	96	108	115	—
ZM	—	—	163	183	220	262	306	—	—	—

Normalized strokes: 50, 80, 100, 125, 160, 200, 250, 320, 400, 500, 630, 800, 1000, 1250, 1600, 2000

HOW TO OTDER

Orders coded in the way showed below should be forwarded to the manufacturer.

UCD	6		16					*
------------	----------	--	-----------	--	--	--	--	----------

**Hydraulic cylinder
with piston rods on both sides**

**Mounting
foot**

Piston rod end:
External metric thread = MZ
Internal metric thread = MW

Nominal pressure MPa

Series number:
02 = 02
(00 - 09) installation and connection dimension unchanged

**Piston dia
against the table**

**Piston rod dia
against the table**

**Piston stroke
against the table**

Further requirements to be added in text (to agree with manufacturer)

Coding example
UCD6MZ16-02-80-45-100

For special requirements, please, contact the manufacturer.

PONAR WADOWICE S.A.
ul. Wojska Polskiego 29
34-100 Wadowice
tel. 033/ 823 39 43, 823 30 41
fax 033/ 873 48 80
e-mail: ponar@ponar-wadowice.pl

