

INSTALLATION DRAWING

PRELIMINARY EDITION

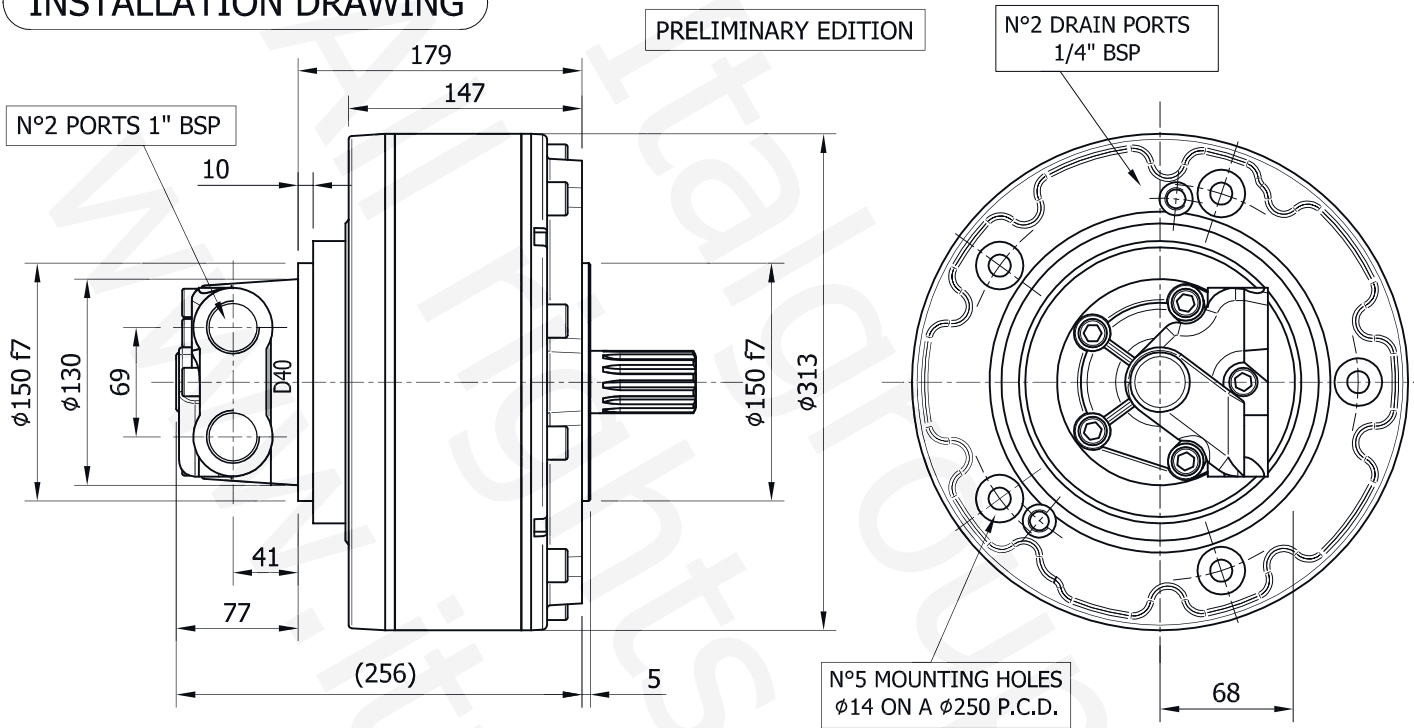

TECHNICAL DATA

		200	250	300	350	400	500	600	650
DISPLACEMENT	[cc]	193	251	305	348	424	493	566	624
SPECIFIC TORQUE	[Nm/bar]	3.06	4	4.84	5.52	6.76	7.84	9	9.92
MAX. CONT. PRESSURE	[bar]	250	250	250	250	250	250	250	250
MAX. INT. PRESSURE	[bar]	320	320	320	320	320	320	320	320
PEAK PRESSURE	[bar]	350	350	350	350	350	350	350	350
MAX. CONT. SPEED	[rpm]	750	650	650	550	550	450	450	400
PEAK SPEED (**)	[rpm]	950	850	850	750	750	650	650	600
MAX. CONT. POWER (***)	[kW]	52	52	52	52	52	52	52	52
PEAK POWER (****)	[kW]	70	70	70	70	70	70	70	70
MAX. CASE PRESSURE	[bar]	6	6	6	6	6	6	6	6
DRY WEIGHT	[kg]	53	53	53	53	53	53	53	53
TEMPERATURE RANGE (*)	[°C]	-30÷70	-30÷70	-30÷70	-30÷70	-30÷70	-30÷70	-30÷70	-30÷70

(\*) Please refer to the "Hydraulic fluid recommendations"

(\*\*) Do not exceed maximum power

(\*\*\*) For motor operation with a continuous duty cycle at maximum continuous power the motor flushing is required

(\*\*\*\*) For motor operation at peak power flushing is usually required. For more information please contact our technical department

SHAFT CONFIGURATIONS

A0

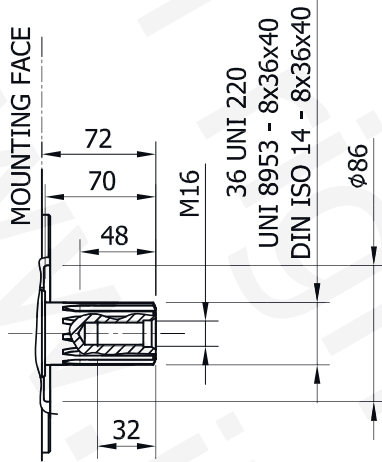

A1

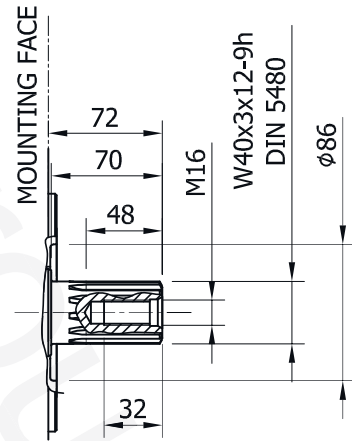

A2

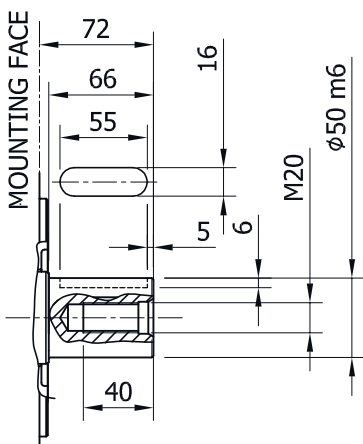

A3

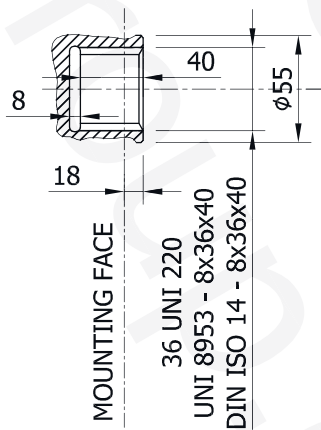

A31

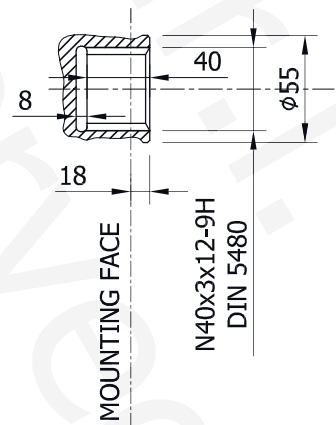

SPLINE BILLETS

SB3

